



PepperBall®
SAFER OPTIONS

ELECTRONIC LOADER

EL-2™

User Manual

PEPPERBALL.COM



ELECTRONIC LOADER

EL-2™

QUICK START GUIDE PAGE 3

BATTERY INSTALLATION PAGE 4

DISASSEMBLY PAGE 5

EXPLODED VIEW PAGE 6

PARTS LIST PAGE 7

MAINTENANCE PAGE 8

WARRANTY AND DISCLAIMER PAGE 9

RETURNS PAGE 10

QUICK START GUIDE



SPECIFICATIONS

This loader is designed specifically for use with 68 cal. PepperBall® projectiles.

- Feeds 20 PepperBall® Projectiles/sec
- Fast Battery Change
- 180 Projectile Capacity
- One Touch for unjamming
- Ultra Lightweight
- Requires Two 9 Volt Batteries
- Fast Disassembly
- 1 Year Warranty

QUICK SET UP GUIDE

1. Install the batteries following the “Battery Installation” instructions on Page 3
2. Mount the PepperBall® loader onto your launcher. Make sure the loader feedneck is pushed down as far as possible into your launcher’s feedneck for the most secure fit. Be careful not to over tighten your launcher’s feedneck as it may damage the feedneck of your PepperBall® loader.
3. To turn on your PepperBall® loader, push and hold the On/Off button located on the rear of the loader under the LED light. You will hear the loader spin if there are no projectiles in the feedneck and the LED light will blink Blue - full battery, Green - medium battery and Red - low battery.
4. Fill your PepperBall® loader with PepperBall® projectiles. This feeds the projectiles into the feedneck and breach of your launcher and the motor of your PepperBall® loader will stop spinning.
5. Turn off your PepperBall® loader by pressing and holding the On/Off button until you see the red light and then release the On/Off button. Also your PepperBall® loader will automatically shut off in one of two ways:
 - A. 60 minutes power down if eyes are blocked (motor not running)
 - B. 10 minutes power down if eyes are unblocked motor running.



BATTERY INSTALLATION

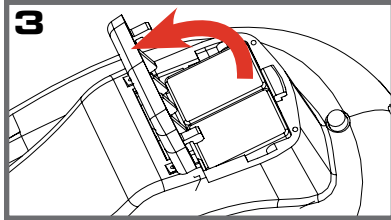
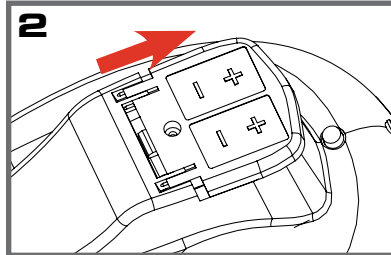
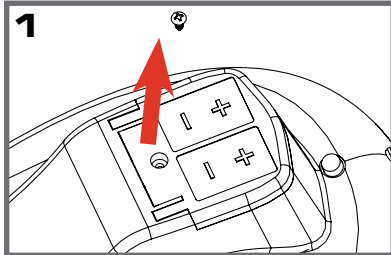

1. Remove the single screw on the under side of the battery door. NOTE: This screw is optional and not needed to retain the battery door.
2. Slide the battery door toward the rear of the loader.
3. Open the battery door and load two (2) 9 Volt batteries according to the diagram on the outside of the battery door. Close the battery door and replace optional screw if desired.

REMOVING THE LID

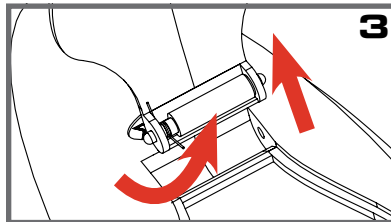
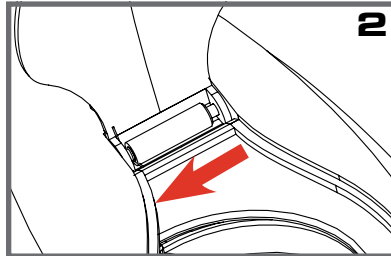
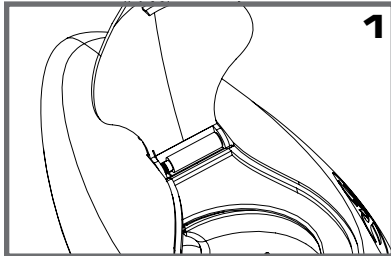

1. Open the lid.
2. Push the hinge pin barrel to the left to disengage the right side of the lid hinge.
3. Pull the right side of the hinge upward and rotate the left side of the hinge out of the socket in the top shell.

DISASSEMBLY

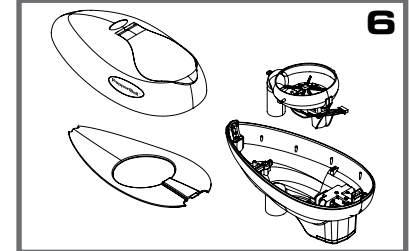
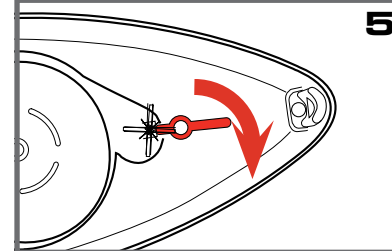
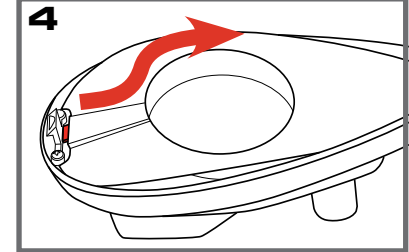
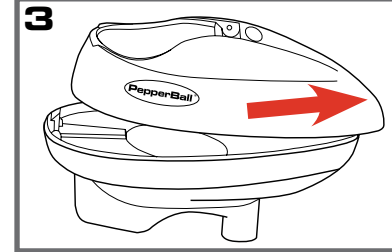
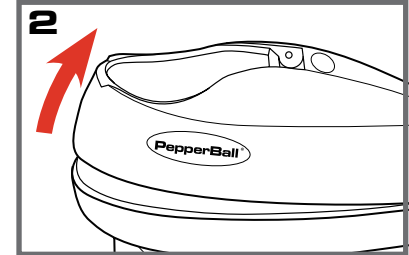
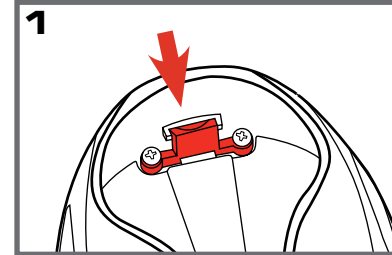

1. Press down on the rear latch on the interior of the loader toward the front of the loader. NOTE: The latch is under constant tension.
2. Lift the top shell while the rear latch is pressed forward until the top shell is free.
3. Push the top shell forward to disengage the front latch and remove the top shell completely.

4. Remove the center plate by gripping the inside edge and top of the plate. Pull the tab out from under the rear latch, then the front latch to free the plate.
5. Remove the Drive Assembly by rotating the cup latch 90 degrees and disconnecting the wiring harness.
6. Clean any debris from the loader and interior with a non-abrasive cloth. **WARNING: Do not get the board or electrical components wet.**



EXPLODED VIEW

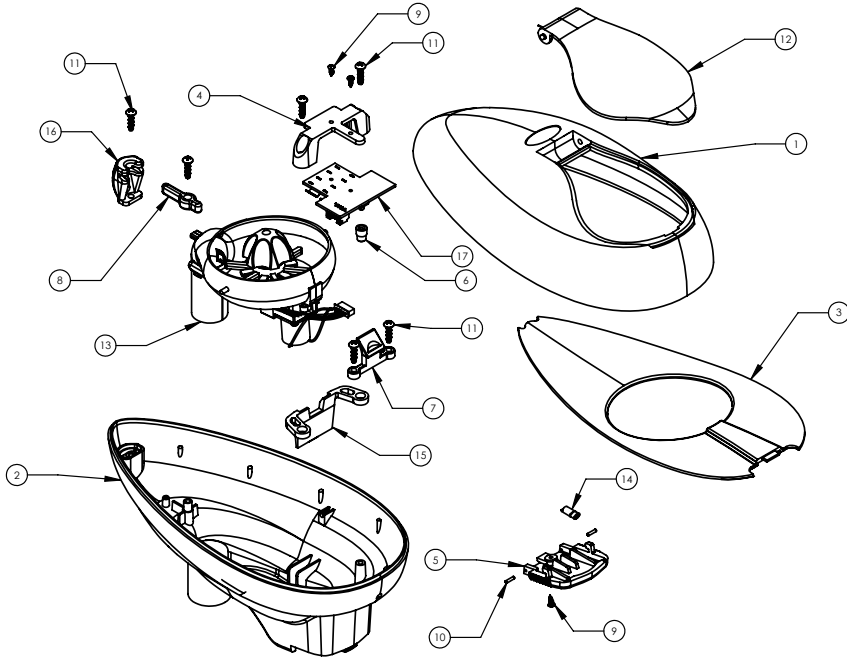

PARTS LIST

ITEM	PART #	DESCRIPTION	QUANTITY
1	EL-PO 001	Top Shell	1
2	EL-PO 002	Bottom Shell	1
3	EL-PO 006	Plate	1
4	EL-PO 009	Battery Hold Down	1
5	EL-PO 010	Battery Door	1
6	EL-PO 013	On/Off/Unjamming Button	1
7	EL-PO 014	Latch Hook-Rear	1
8	EL-PO 042	Cup Latch Hook-Rear	1
9	EL-PO 011	#2 X .25 screw 8-1/8 SS	3
10	EL-PO 037	.0625 X .270 Dowel Pin	2
11	EL-PO 040	6-19 X .50 Screw 8-1/8 SS	6
12	EL-PO 005	Lid Assembly	1
13	EL-PO 003	Drive Assembly	1
14	EL-PO 047	Light Pipe	1
15	EL-PO 048	Battery Guide	1
16	EL-PO 051	Latch Hook Front R2	1
17	EL-PO 001	Main IR PCB	1

IMPORTANT USE INFORMATION

- Read, understand and follow all directions in the PepperBall® loader owner's manual.
- If engaged in force on force training, you must wear eye protection that is designed specifically for impacts of projectiles and meets ASTM/CE standards and make sure all persons within range wear the same eye protection.
- You must be 18 years old or older to own and operate this loader.
- Make sure you understand all instructions. If you are unsure how to operate the loader, contact PepperBall® at Service@PepperBall.com or call 1.877.887.3773.
- **The loader should be used by less lethal trained personnel only.**



TROUBLESHOOTING

- **PepperBall® loader will not turn on when pressing the On/Off button.**

- Check the batteries for correct polarity alignment.
- Check the battery strength and replace with fresh, name-brand batteries if necessary.
- If further support is needed, contact the PepperBall® Service Department at Service@PepperBall.com or call 1.877.887.3773 for North America or +1 858-228-1439 for International support.

- **Breaking projectiles in my PepperBall® loader.**

- Make sure to use authentic PepperBall® projectiles in your loader.

- **PepperBall® loader is slow or not performing as usual.**

- Make sure the loader is clean and replace the batteries with fresh, name-brand batteries.

- **Projectiles are jamming.**

- Press on / off button once - rotor should reverse to clear jam.

CLEANING AND MAINTENANCE

- The PepperBall® loader should be disassembled and cleaned:

- When a projectile is broken and debris fragments are present in the loader.
- When dirt or debris enters the loader.
- For routine cleaning every few days of use.

- The PepperBall® loader should be disassembled and cleaned using a non-abrasive cloth. If there is still debris, use a damp cloth to remove the remaining contents.

WARNING: Do not get the board or electrical components wet. Be sure the loader is completely dry before reassembling.

- The PepperBall® loader requires fresh, quality name-brand batteries to achieve optimum performance. The batteries will need to be regularly replaced to get the highest performance from your PepperBall® loader.

WARRANTY AND DISCLAIMER

WARRANTY, DISCLAIMER OF WARRANTY AND LIMITATION OF REMEDIES

United Tactical Systems, LLC (UTS) warrants, solely to the end user, law enforcement agencies, private security firms, or private or public corrections agencies, that the product is delivered free from defects in materials and workmanship for a period of one (1) year from the original date of purchase.

Within the one-year warranty period, UTS's liability and the buyer's sole and exclusive remedy hereunder for all claims shall be limited to a refund or credit to buyer of the purchase price, or replacement of this product, at UTS's option, provided that the non-conforming product is (1) returned during the warranty period and (2) properly packaged and shipped to UTS's designated facility in accordance with UTS's Return Merchandise Authorization (RMA) Policy.

THE REMEDY SET FORTH ABOVE SHALL BE THE SOLE AND EXCLUSIVE REMEDY FOR BREACH OF THE FOREGOING WARRANTY.

Products which have been improperly handled, stored or shipped, or which have been subject to abuse, misuse, alteration and or neglect are not covered by the warranty. Aftermarket products and the use of non-authorized projectiles are strictly prohibited by UTS and any indication of their installation or use shall void all warranties.

DISCLAIMER OF WARRANTY: Except for the express limited warranty set forth above, UTS makes no warranties or representations of any kind, whether express or implied, with respect to the product, including any (a) warranty of merchantability; or (b) warranty of fitness for a particular purpose; or (c) warranty against infringement of intellectual property rights of a third-party, whether express or implied by law, course of dealing, course of performance, usage of trade or otherwise. There are no warranties which extend beyond the description of the face hereof. Buyer shall make no warranty or representation regarding the products that is inconsistent with the warranty set forth above. UTS shall not be liable for any injury, loss, or damage, direct or consequential, arising out of the use or the inability to use this product.

Before use, the user shall determine the suitability of the product and be fully trained for its intended use, and user assumes all risks and liability whatsoever in connection therein. In no event shall UTS be liable or obligated to buyer or to any third party in any manner for any (a) special, non-compensatory, consequential, indirect, incidental, statutory, or punitive damages of any kind, including, without limitation, lost profits and/or lost revenue, regardless of the form of action, whether in contract, tort, negligence, strict product liability, or otherwise, even if informed of or aware of the possibility of any such damages in advance, (b) in an amount greater than the amounts paid to UTS by buyer for the products, or (c) damage or injury caused by the products, unless due to the gross negligence or willful misconduct of UTS. The limitations set forth above shall be deemed to apply to the maximum extent permitted by applicable law and notwithstanding the failure of the essential purpose of any limited remedies. The parties acknowledge and agree that they have fully considered the foregoing allocation of risk and find it reasonable, and that the foregoing limitations are an essential basis of the bargain between the parties.



UTS RETURN MERCHANDISE AUTHORIZATION (RMA) POLICY

For warranty and non-warranty repair:

- Call UTS at 1-260-478-2500
- UTS will issue a Return Authorization (RA) number
- UTS will provide the shipment address.
- Include a brief statement regarding the requested repair, your name, your return address and a telephone number where you can be reached during normal business hours.
- CAUTION: ALWAYS UNLOAD AND REMOVE AIR SOURCE AND PROJECTILES BEFORE SHIPPING A LAUNCHER.
- CAUTION: THE AIR SOURCE MUST BE DISCHARGED.
- Please make sure that the RA number is clearly marked on the outside of the package.
- Postage and delivery charges must be pre-paid. Collect delivery charges will not be accepted.
- Products within the one-year warranty period are returned via ground shipping at no charge.
- Out-of-warranty returns require a pre-payment of shipping charges prior to return shipment by UTS.
- You may request expedited shipping at your expense with charges paid prior to return shipment.

UTS strives to complete the necessary repair work within a reasonable amount of time.

PepperBall® A Division of United Tactical Systems, LLC

www.pepperball.com | (858) 638-0236
28101 Ballard Drive, Suite F
Lake Forest, IL 60045

NOTES



HEADQUARTERS

28101 Ballard Dr. Ste. F
Lake Forest, IL 60045

1-877-887-3773 | North America
+1-858-228-1439 | International
PEPPERBALL.COM

PepperBall® is a registered trademark of United Tactical Systems, LLC,
exclusive worldwide manufacturer and supplier of genuine PepperBall® products